



Location

Distance from the Airport: 14 km.

City Centre: 0.5 km.

This hotel features an absolute waterfront position in the historic Rocks area. Major shopping, transportation, restaurant and tourist areas are all within easy walking distance. Darling Harbour and Circular Quay are just around the corner.

Distinctive features

The delightful heritage renovation and sleek modern design of the lobby, provides extensive views of Walsh Bay and Sydney Harbour. A 12 square metre glass floor affords floodlit views to the harbour below. Tie up and come aboard The Sebel Pier One Sydney via our floating pontoon. The pontoon also provides the ideal launching pad for your water based team building activities or for the bride and groom to arrive in style!

Superb accommodation with 'Sebel style' service and attention to detail. A variety of excellent restaurants and cafés are located nearby.

Accommodation

161 well appointed guest rooms, 79 featuring magnificent water views of Sydney Harbour, 10 elegant suites and 19 beautiful king rooms.

Guestroom features and facilities

- Well proportioned guestrooms and suites
- Magnificent views of Walsh Bay and Sydney Harbour
- Duvet
- Individually controlled air-conditioning
- Writing tables
- Private in-room bar
- Tea and coffee making facilities
- Data points
- Voice mail
- Wireless internet access in some rooms
- Iron and ironing board
- Bathrobes, hairdryers and bathroom amenities
- In-room safes
- Alarm clock
- Electronic room key
- Remote controlled TV

Guest services

- 24-hour reception, concierge and room service
- Daily housekeeping
- Valet dry-cleaning and laundry
- Express check-out
- Valet parking
- Water taxis
- Wheelchair accessible facilities
- 24-hour business facilities with facsimiles, email, internet, scanners, colour printers and phone lines
- Non-smoking rooms
- Complimentary daily newspaper

Guestroom layout

Superior Room
Average Size - 28m²



Meetings and events

Vibrant, cosmopolitan Sydney is the best location for a conference, seminar or product launch. Enjoy a wealth of entertainment, dining and cultural events, ideal for an incentive based meeting.

The Sebel Pier One's splendid location is perfect for meetings and conferences, celebrations, elegant cocktail gatherings, and of course beautiful weddings. With a dedicated functions team, the hotel ensures a highly successful event, whatever the occasion.

Conference room layouts

The fabulous **Harbour Watch**, is a stunning location for cocktail parties, product launches, weddings and gala dinners for up to 350 guests. Situated at the front of the pier, Harbour Watch enjoys unrivalled views of Sydney Harbour, Luna Park, the Harbour Bridge and out towards the Heads. North Sydney's evening lights combine with the harbour's sparkling waters to create a truly breathtaking backdrop.

Dawes Point Conference Centre

features three variable space meeting rooms with floor to ceiling natural light and state-of-the-art audio visual equipment. This superior function facility has its own direct access to the pier, spectacular views and is one of Sydney's prime meeting and seminar venues.

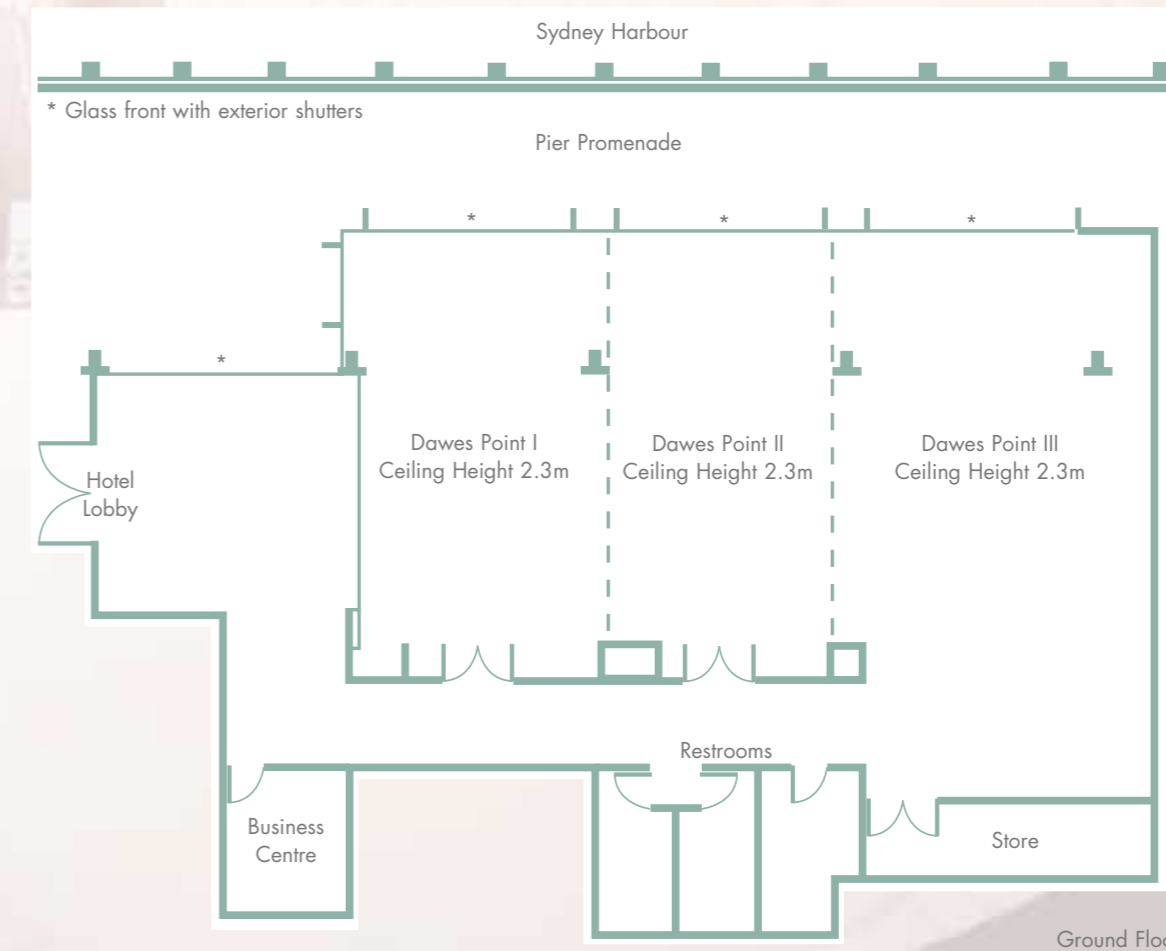
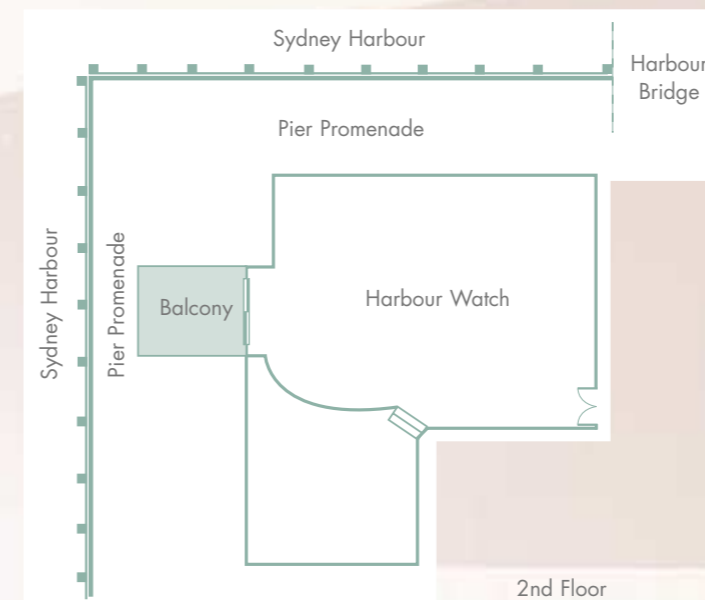

VENUE	THEATRE	CLASSROOM	U-SHAPE	BOARDROOM	DINING	COCKTAIL	AREA METRES SQ
The Bridge Room	80	45	25-30	20	60	100	97
Harbour Watch	180	110	60	60	280	300	226
Dawes Point I	60	18	20	20	50	80	60
Dawes Point II	40	12	15	15	30	50	53
Dawes Point III	80	24	30	20	50	80	80
The Dawes Point Room	160	60	-	-	120	200	193
Hickson Room	40	24	18	15	30	50	42

Conference equipment

- Secretarial services
- Theming and entertainment
- Pre and post conference activities
- Place cards
- Personalised menus
- Pads, pens, mints and iced water on tables
- Overhead projector and screen
- Whiteboard
- Flipchart
- Data projectors
- TV and video
- Wireless internet access
- Additional audio visual equipment and presentation aids available on request.

**THE SEBEL
PIER ONE**

SYDNEY

11 Hickson Road

Walsh Bay Sydney

NSW 2000 Australia

T 61 2 8298 9999

F 61 2 8298 9777

Free Call 1 800 780 485

Central Reservations 13 15 15

reservations@spos.mirvac.com.au

www.mirvac-hotels.com



Recreation and fitness

- ✎ Well equipped gymnasium
- ✎ Private pontoon
- ✎ Arrangements made for tennis, golf, harbour cruises, sailing, BridgeClimb, diving, harbour jet and an array of other activities.

Restaurant and bar

Front Restaurant and Bar - relax and enjoy spectacular views of Walsh Bay and Sydney's majestic harbour. Stunning sunset views are the perfect complement for dining either inside the restaurant or alfresco on the pier.

An extensive and exciting in-room dining menu is also available for casual, private dining.

Nearby attractions

- ✎ Harbour cruises
- ✎ Sydney Opera House
- ✎ The Rocks
- ✎ Sydney Harbour Bridge
- ✎ Fort Denison
- ✎ Taronga Park Zoo
- ✎ Darling Harbour
- ✎ Circular Quay
- ✎ Powerhouse Museum
- ✎ Sydney Aquarium
- ✎ Museum of Contemporary Art
- ✎ Sydney Theatre Company
- ✎ Maritime Museum
- ✎ BridgeClimb

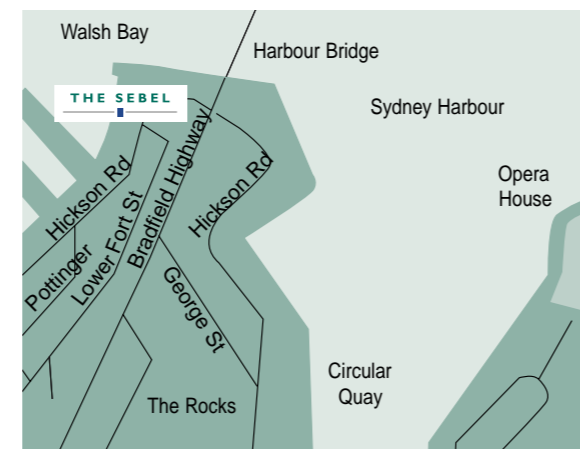

www.mirvachotels.com

Welcome to **The Sebel Pier One Sydney**, superbly located

in the historic Rocks area on the waterfront, adjacent to Sydney's famous Harbour Bridge.

Its unique blend of Federation building and contemporary chic architecture, provide a rich fusion of heritage legacy and modern lifestyle.

Overlooking Walsh Bay, The Sebel Pier One Sydney is an exceptional hotel, ideal for the leisure traveller, conference and meeting delegate, distinctive weddings or those visiting Sydney on business.